

PLAN OF ATTENUATION CATCHMENT AREA: A (SCALE 1:250)

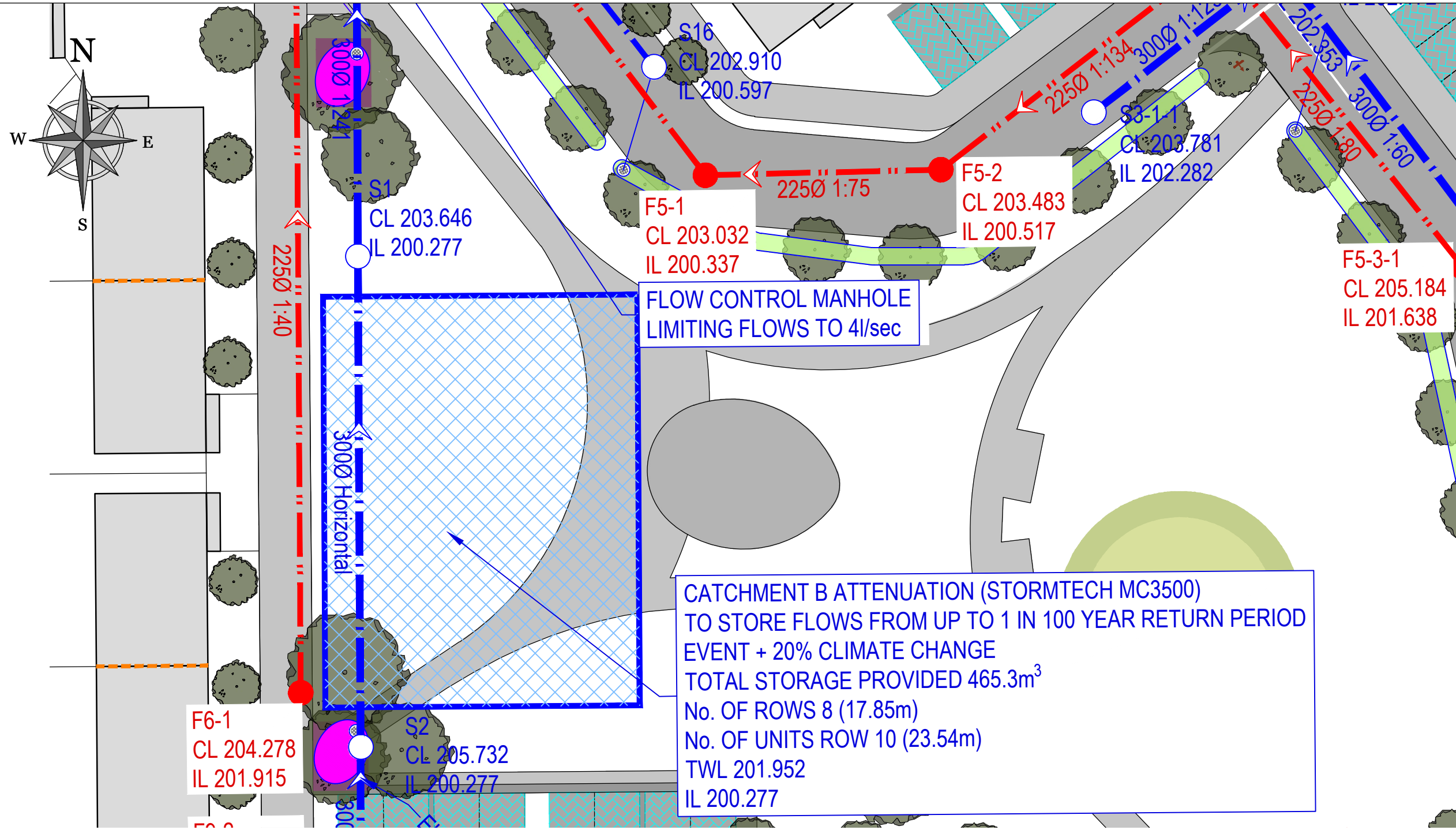

PLAN OF ATTENUATION CATCHMENT AREA: B (SCALE 1:250)

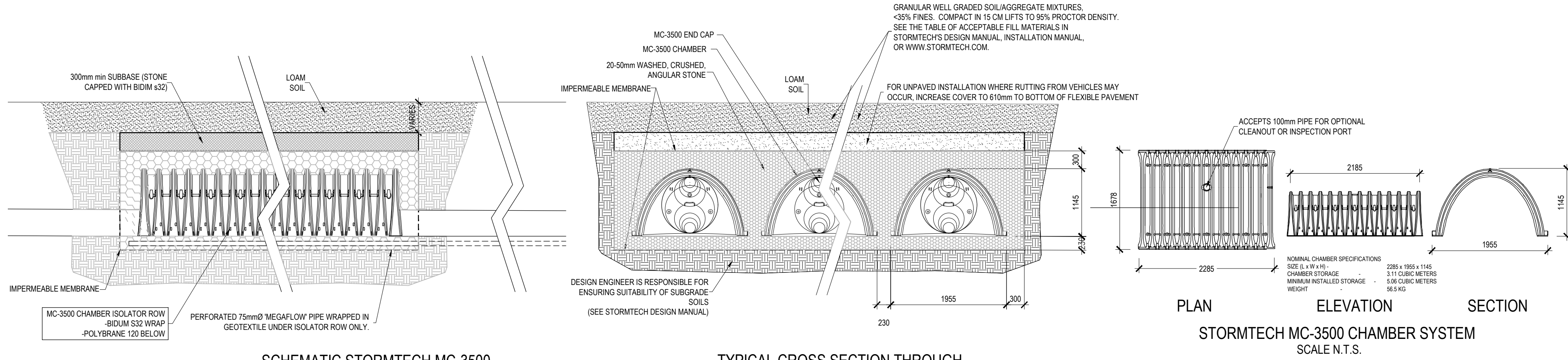

SCHEMATIC STORMTECH MC-3500 CHAMBER SYSTEM LONGITUDINAL SECTION SCALE 1:50

TYPICAL CROSS SECTION THROUGH STORMTECH MC-3500 CHAMBER SYSTEM SCALE 1:50

PLAN ELEVATION SECTION STORMTECH MC-3500 CHAMBER SYSTEM SCALE N.T.S.

SURFACE WATER STORAGE TANK A - STORMTECH MC-3500 SCALE AS SHOWN

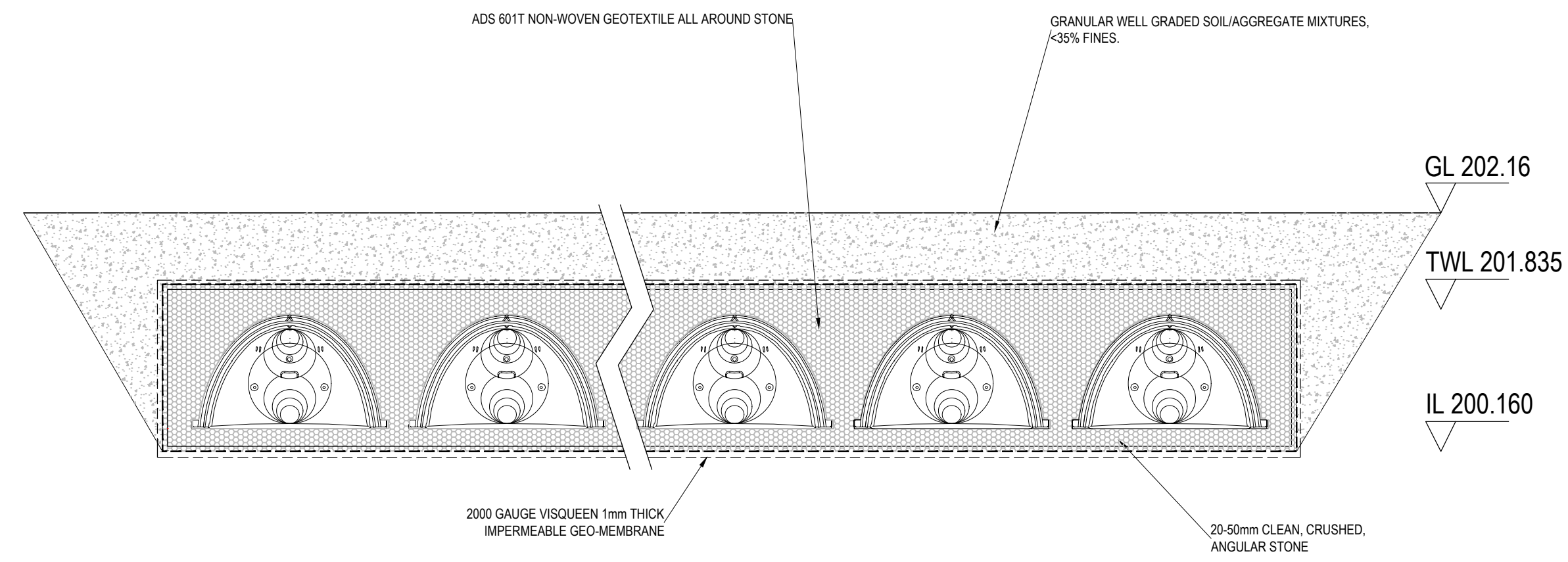

CROSS SECTION A-A THROUGH ATTENUATION FACILITY 8 UNITS WIDE SCALE 1:50

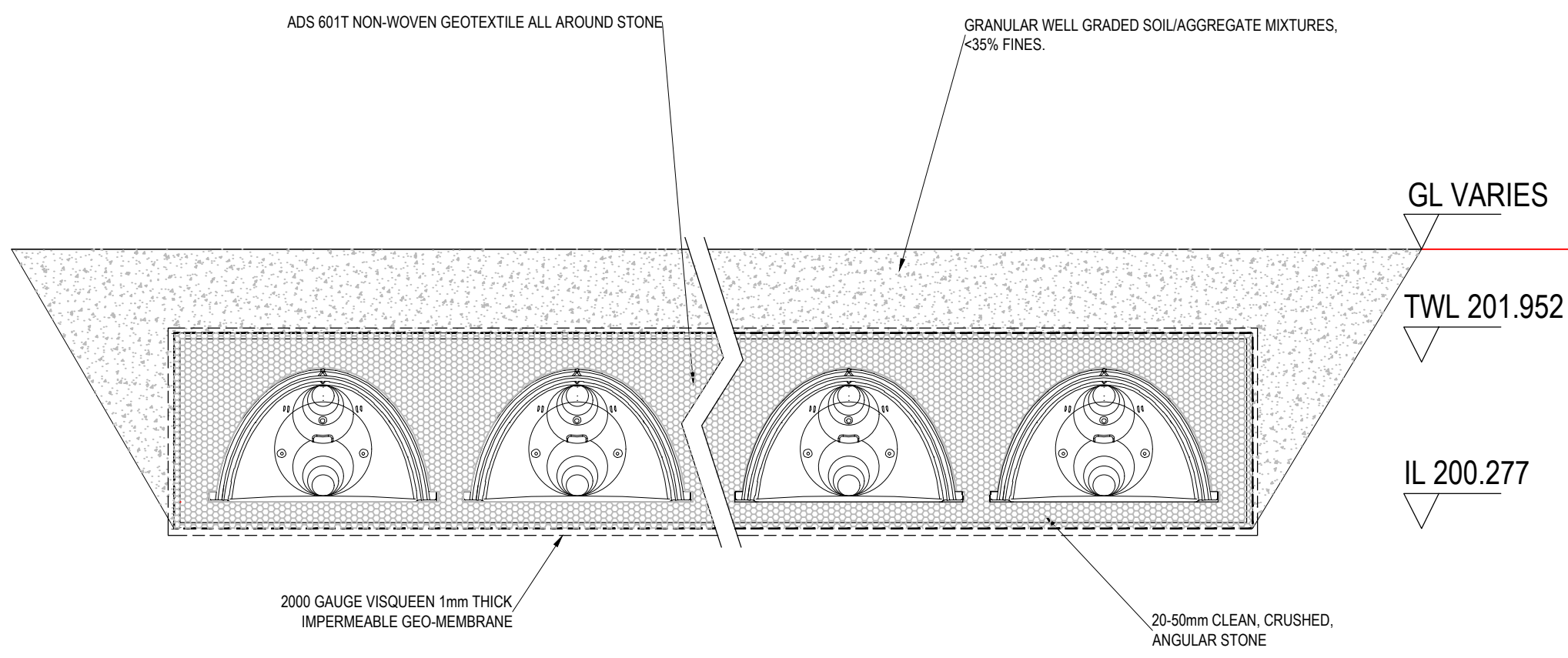

CROSS SECTION B-B THROUGH ATTENUATION FACILITY 8 UNITS WIDE SCALE 1:50

ON ORIGINAL

0 10 20 30 40 50mm

© COPYRIGHT OF THIS DRAWING IS RESERVED BY DBFL CONSULTING ENGINEERS. NO PART SHALL BE REPRODUCED OR TRANSMITTED WITHOUT THEIR WRITTEN PERMISSION.

NO CHANGES OF WHATSOEVER NATURE ARE TO BE MADE TO ANY DETAILS SET OUT OR CONTAINED IN ANY DBFL SPECIFICATIONS OR DRAWINGS UNLESS THE EXPRESS CONSENT HAS BEEN OBTAINED IN ADVANCE, IN WRITING, FROM DBFL.

GENERAL NOTES:

1. ALL WORKS SHALL BE CONSTRUCTED IN ACCORDANCE WITH THE WORKS REQUIREMENTS.
2. ALL DIMENSIONS IN METRES UNLESS SPECIFIED OTHERWISE.
3. ALL CO-ORDINATES ARE TO IRISH TRANSVERSE MERCATOR.
4. ALL LEVELS ARE TO ORDNANCE DATUM (MALIN HEAD).
5. ALL TEMPORARY TRAFFIC & OPERATIONS MANAGEMENT SHALL COMPLY FULLY WITH THE WORKS REQUIREMENTS.
6. THE CONTRACTOR MUST LIAISE DIRECTLY WITH LOCAL AUTHORITY DEPARTMENTS AS DIRECTED IN THE WORKS REQUIREMENTS.
7. ALL VEHICULAR & PEDESTRIAN, CYCLE & PRIVATE ACCESS ROUTES WITHIN AND SURROUNDING THE WORKS EXTENTS MUST BE MAINTAINED THROUGHOUT THE WORKS IN ACCORDANCE WITH THE CONTRACTORS APPROVED TEMPORARY TRAFFIC & OPERATIONS MANAGEMENT PLAN.

DRAWING SPECIFIC NOTES:

1. ALL DRAWINGS TO BE CHECKED BY CONTRACTOR ON SITE AND ENGINEER INFORMED OF DISCREPANCIES BEFORE WORK COMMENCES.
2. CONTRACTOR SHALL SATISFY HIMSELF AS TO THE ACCURACY OF EXISTING DRAINAGE LEVELS & SERVICES ON SITE PRIOR TO COMMENCEMENT OF WORKS ON SITE.
3. ALL WORKS TO BE CONSTRUCTED IN ACCORDANCE WITH THE NRA SPECIFICATION FOR ROAD WORKS UNLESS NOTED OTHERWISE.
4. MANHOLE COVER LEVELS ARE TO CONFORM WITH FINISHED ROAD AND PATH LEVELS.
5. ALL DRAINAGE TO BE AS PER THE LOCAL AUTHORITY CODE OF PRACTICE FOR DRAINAGE WORKS/LOCAL AUTHORITY & IRISH WATER REQUIREMENTS.
6. ALL EXTERNAL COLLECTOR DRAINS TO BE MINIMUM 150 mm DIA.
7. ALL FOUL SEWERS TO BE UPVC TO EN1401.
8. ALL SURFACE WATER SEWERS TO BE CLASS H CONCRETE TO EN1916 & IS 6 2004.
9. CONTRACTOR SHALL INSPECT THE ROUTE & CONFIRM LOCATIONS OF ALL TREES, FEATURES, ENTRANCES & ASPECTS IMPACTING CONSTRUCTION OF THE WORKS.

LEGEND:

- SITE BOUNDARY
- PROPOSED SURFACE WATER
- SW ATTENUATION TANK
- EXISTING LEVELS
- PROPOSED EXISTING LEVELS
- PERMEABLE PAVEMENT
- EXISTING SURFACE WATER
- EXISTING FOUL SEWER
- BASEMENT FOOTPRINT

ORDNANCE SURVEY IRELAND LICENCE
No EN 0017921
© ORDNANCE SURVEY IRELAND
GOVERNMENT OF IRELAND

0	09-08-24	ISSUED FOR PLANNING	HvH	SPB
rev	date	description	by	chkd.
STATUS CODES				
purpose	P1 - INFORMATION	acceptance	S - ISSUED	
DBFL CONSULTING ENGINEERS				
T + 353 1 400 4000 E: info@dbfl.ie W: www.dbfl.ie				
DUBLIN CORK GALWAY WATERFORD				
project ref.				
BLESSINGTON LRD				
drawing title				
TYPICAL ATTENUATION DETAILS SHEET 2				
client				
MARSHALL YARDS DEVELOPMENT COMPANY LTD				
designed by	XXX	author	HvH	scale
drawing no.	230199-X-91-200-DTM-DR-DBFL-CE-5306	revision	0	sheet size
				A1